



## 21 Dean Gardens

East Sussex, BN41 2FW

**£1,895 PCM**

3 BEDROOM FAMILY HOME | LARGE KITCHEN + CONSERVATORY | GENEROUS LIVING SPACE | PORTSLADE LOCATION

A well-presented three-bedroom family home located on Dean Gardens in Portslade, offering excellent living space and a practical layout ideal for families or professional sharers.

The property features a spacious main living room, providing a comfortable and versatile area for both relaxing and entertaining.

To the rear, a large kitchen opens through to a bright conservatory, creating an additional reception space overlooking the garden — ideal as a dining area, second lounge, or home working space.

Upstairs, the property comprises:

- A generous principal bedroom (large double)
- A second bedroom (small double)
- A third bedroom, suitable as a child's room, guest room, or office
- A family bathroom located on the first floor

Externally, there is a well-maintained private garden, offering a good level of outdoor space.

The property is situated in a convenient residential location, close to local amenities, schools, and transport links.

- Three-bedroom family home
- Spacious main living room
- Large kitchen with adjoining conservatory
- Private rear garden
- First floor family bathroom
- Generous principal bedroom (large double)
- Good natural light throughout

### Viewing

Please contact our Pavilion Properties Office on 01273 686 306 if you wish to arrange a viewing appointment for this property or require further information.



## Floor Plan

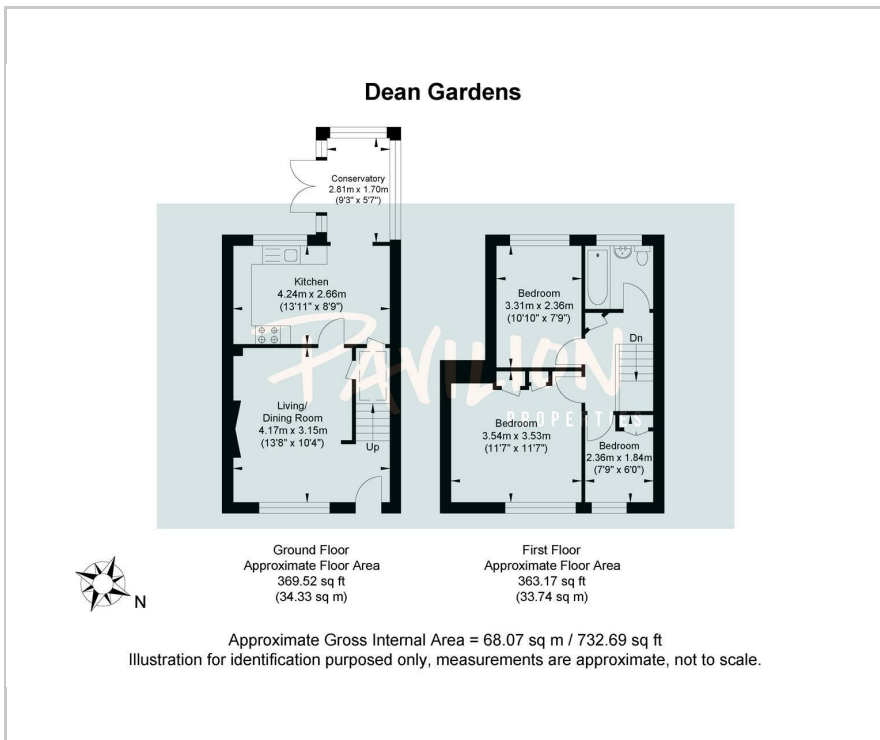

## Area Map



## Energy Efficiency Graph

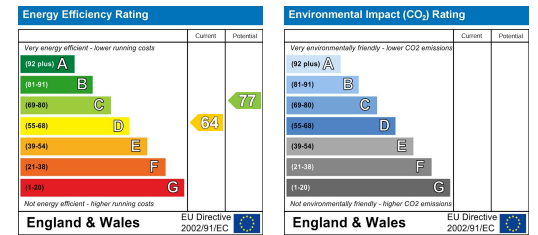

These particulars, whilst believed to be accurate are set out as a general outline only for guidance and do not constitute any part of an offer or contract. Intending purchasers should not rely on them as statements of representation of fact, but must satisfy themselves by inspection or otherwise as to their accuracy. No person in this firm's employment has the authority to make or give any representation or warranty in respect of the property.